



GRAIN MILL

Care and Use Guide



Features:

- High quality, durable tin-coated cast iron
- Large capacity hopper, grinds 1 lb. per minute, coarse to fine
- Removable poly handle allows for continuous operation
- Adjustable table clamp, easy to set-up, use and clean
- Create authentic breads and baked goods - made from scratch

For your safety and continued enjoyment of this product, always read the instruction book carefully before using.

LIST OF COMPONENTS

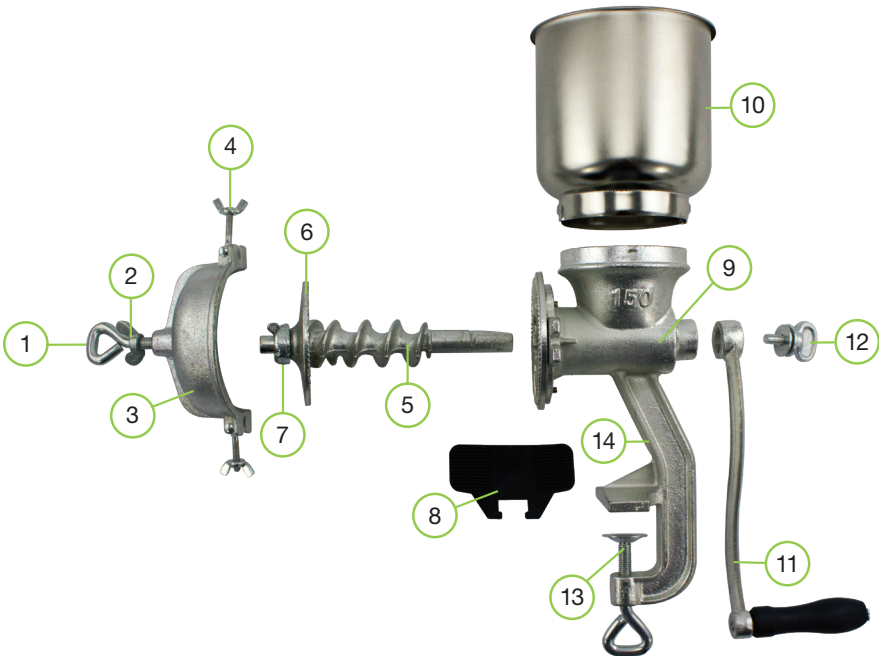

Parts List

- | | |
|----------------------------------|--------------------------|
| 1. Grinding Plate Pressure Screw | 8. Rubber Protector Pad |
| 2. Wing Nut | 9. Grinder Body |
| 3. Shield | 10. Hopper |
| 4. Rotating Thumbscrew w/ Bolt | 11. Handle |
| 5. Auger | 12. Thumbscrew w/ Washer |
| 6. Adjustable Grinding Plate | 13. Clamping Thumbscrew |
| 7. Retainer Cap | 14. Grinder Body Foot |

IF MISSING PARTS, PLEASE CALL CUSTOMER SERVICE AT 1-800-288-4545.
DO NOT RETURN ITEM TO STORE.

HOW TO USE

Read and follow instructions and warnings prior to using this product.

WARNING

Indicates a potentially hazardous situation which, if not avoided, could result in death or serious injury.

1. Read all of the instructions below before using the Chard Grain Mill.
2. Keep the Grain Mill out of reach of children.
3. Never put your fingers or hands into the Grain Mill, as this may cause serious injury.
4. Eye protection should be worn while operating the Grain Mill.

Cleaning

1. Before using for the first time, disassemble and thoroughly clean all parts with hot soapy water. Rinse with hot water and towel dry thoroughly, do not allow any parts to air dry as this can lead to corrosion.
2. The Chard Grain Mill is not dishwasher safe, placing the product in the dishwasher will cause damage.

Assembly

1. Clamp the Grain Mill body (#9) to a sturdy bench or table with the rubber protective pad (#8) placed between the body and bench or the table top.
2. Insert the auger (#5) and adjustable grinding plate (#6) into Grain Mill body (#9).
3. Install the shield (#3) with grinding plate pressure screw (#1) onto Grain Mill body (#9).
4. Align the rotating thumbscrews (#4) into the slots in the Grain Mill body (#9) and tighten securely.
5. Set adjustable grinding plate pressure screw (#1) and then tighten the locking wing nut (#2) against the shield (#3).
6. Place the handle (#11) on end of auger post (#5) and secure using the thumbscrew (#12).
7. Install hopper (#10) on top of Grain Mill body (#9) and twist slightly to lock into place.

Milling Instructions

1. Fill hopper (#10) with product to be ground or milled.
2. Position a bowl under grinding plates to catch millings as it they are being ground.
3. Slowly turn the handle (#11) clockwise.

Adjusting the Coarseness of the grind: Loosen the wing nut (#2) and turn pressure screw (#1) counter clockwise to produce a more course grind or clockwise to produce a finer grind. When the right setting is adjusted, tighten the locking wing nut (#2) to securely set position.

TIP: Whatever is being milled or ground should be dry to prevent caking and ensure a consistent grind. If the mill jams, turn the handle (#11) counter-clockwise to clear jam and then resume (do not use hands to clear jam). For best results turn handle at a constant speed.



LIMITED WARRANTY

Your product is warranted for one year from date of purchase against all defects in material and workmanship. Should your product prove defective within one year from date of purchase or receipt, return the unit, freight prepaid, along with an explanation of the claim. Please package your product carefully in its original box and packing material to avoid damage in transit. We are not responsible for any damage caused to the product in return shipment.

Under this limited warranty, we undertake to repair or replace any parts found to be defective at our sole discretion. This limited warranty is only valid if the product is used solely for household purposes in accordance with the instructions. This limited warranty is void if the unit is connected to an unsuitable electrical supply, or dismantled or interfered with in any way or damaged through misuse.

LIMITATION OF REMEDIES AND DAMAGES: Except for the limited warranty and remedies expressly stated above, the Metal Ware Corp shall not be liable to you, or to anyone claiming by or through you, for any obligations or liabilities, including, but not limited to, obligations or liabilities arising out of breach of contract, breach of warranty, statutory claims, negligence or other tort or any theory of strict liability, with respect to the product or the Metal Ware Corp's acts or omissions or otherwise. Buyer agrees that in no event shall the Metal Ware Corp be liable for incidental, compensatory, punitive, consequential, indirect, special or other damages. Warranty does not cover consequential or incidental damages such as property damage and does not cover incidental costs and expenses resulting from any breach of this warranty, even if foreseeable. Some states or provinces do not allow the exclusion or limitations of incidental or consequential damages, so the above limitation or exclusion may not apply to you depending on the State or Province of purchase.

We ask that you kindly fill in the details on your warranty card and return it within one week from date of purchase.

Send warranty card to:

Chard GM-150 / Grain Mill
C/O MW
P.O. Box 237
Two Rivers, WI 54241

©2018 Metal Ware Corp, P.O. Box 237, Two Rivers, Wi 54241 1-800-288-4545